

Sortierhilfe

Einleger für die Sortierschalen

Version 1.4: Stand 4/2024

technika | Karlsruher-Technik-Initiative

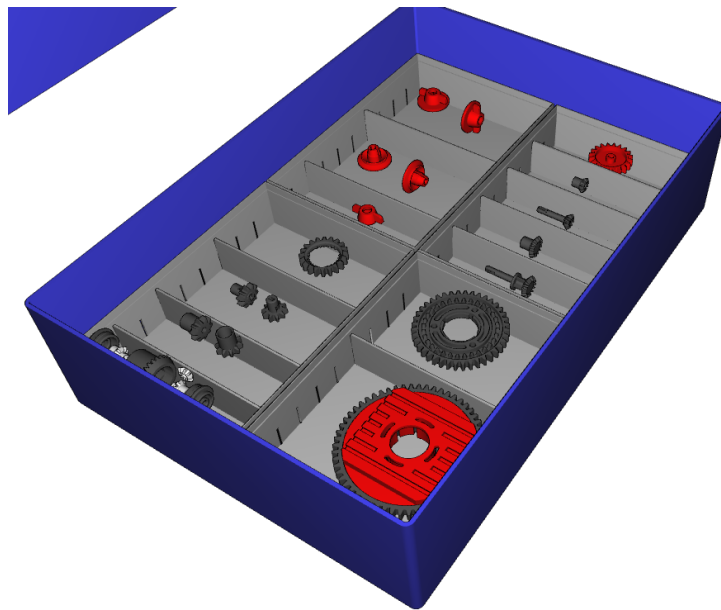

Erzeugt mit dem fischertechnik-Designer (www.fischertechnik-designer.de)

1 A

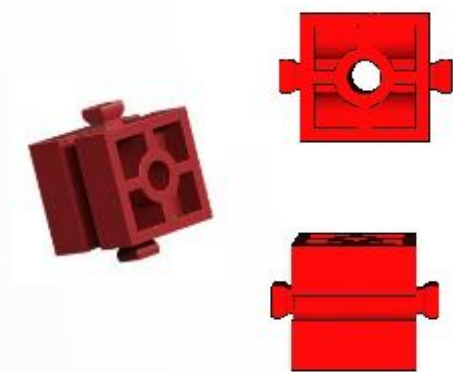

**Baustein 15
mit Bohrung**

1 C

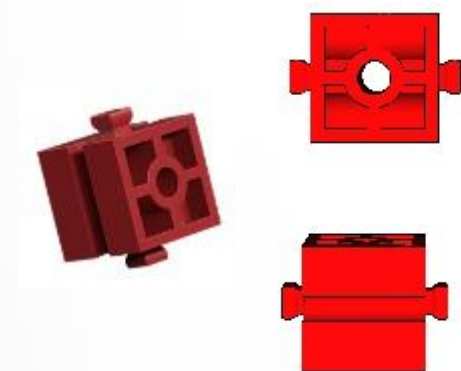

**Baustein 15
mit Bohrung**

1 B

Baustein 15
mit Bohrung

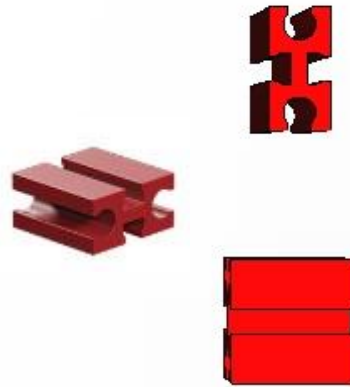
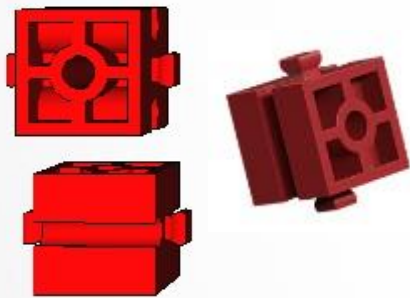

Baustein 7,5

1 D



Baustein 7,5

1 E

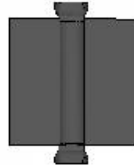

Baustein 15
2 Zapfen

1 G

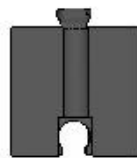

Baustein 15
1 Zapfen



1 F

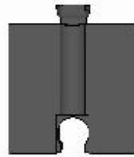

Baustein 15
1 Zapfen

1 H

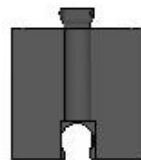

Baustein 15
1 Zapfen

2 A



**Winkelträger 15
1 Zapfen**

2 C

**Winkelträger 15
1 Zapfen**

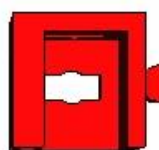

2 B

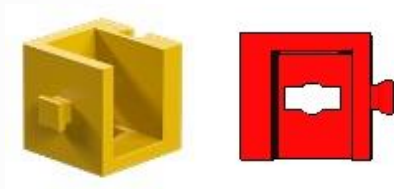

Winkelträger 15
1 Zapfen

2 D

Winkelträger 15
2 Zapfen



2 E

Riegelstein 15x15

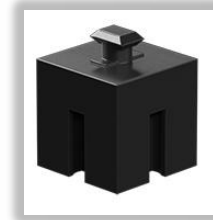

2 G

Statikstein

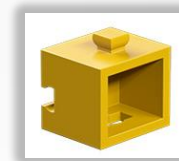
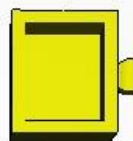

2 F

Baustein V15 Eck

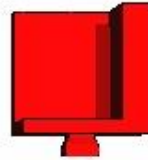

2 H

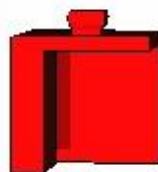

Baustein V15 Eck

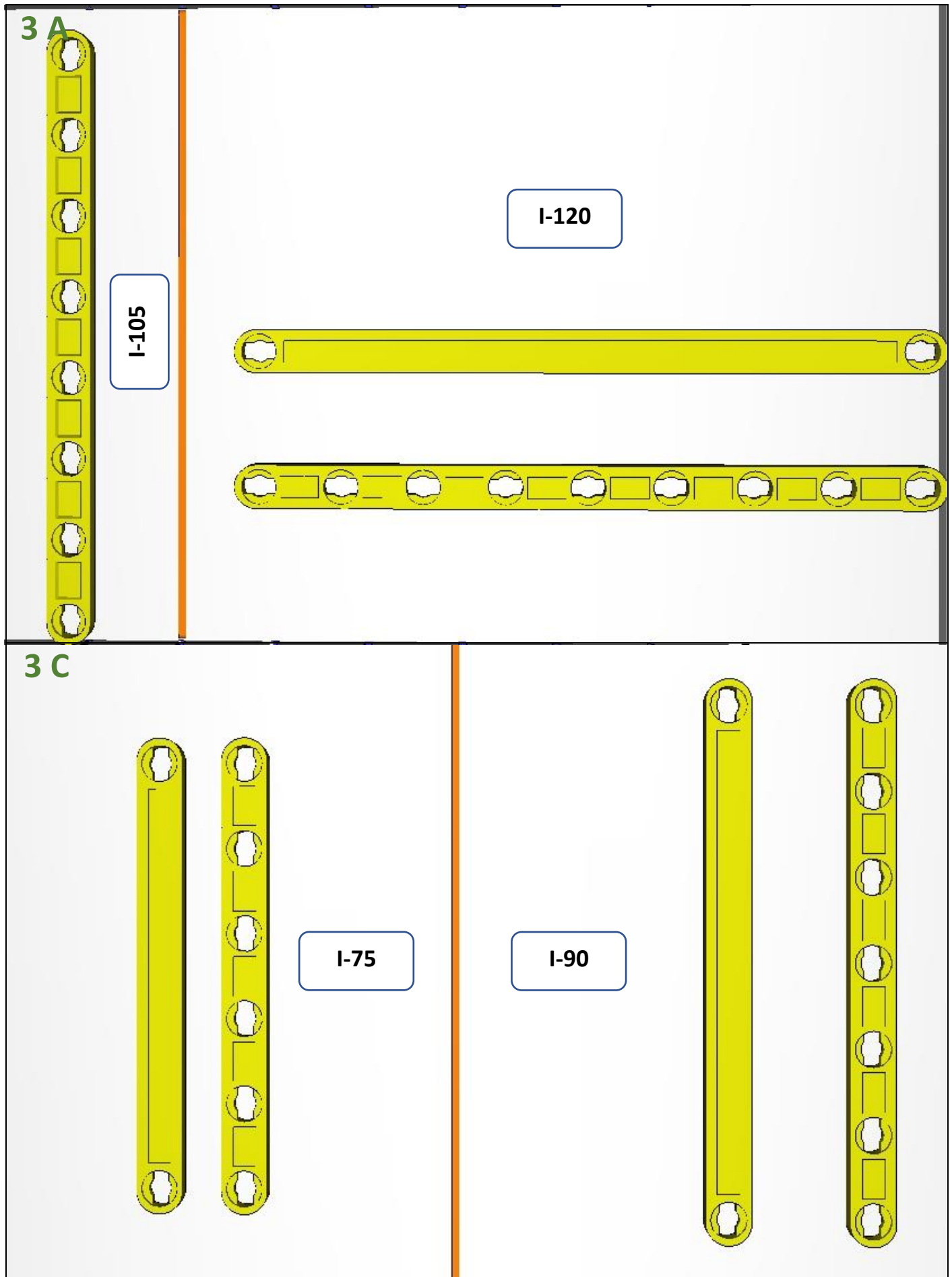

3 B

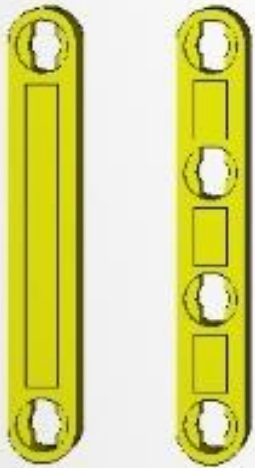

I-45

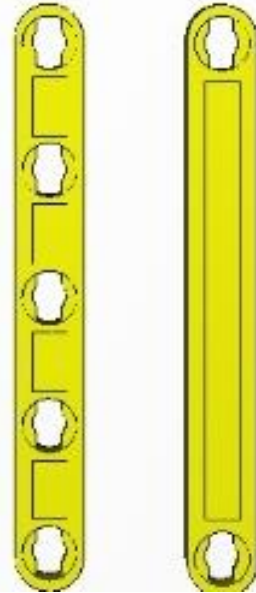

I-60

3 D

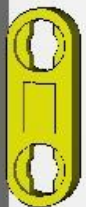

I-15

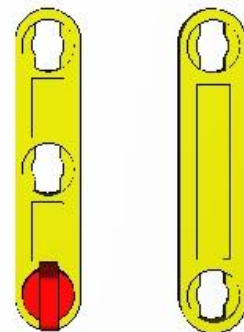

I-30

3 E

X-169,9

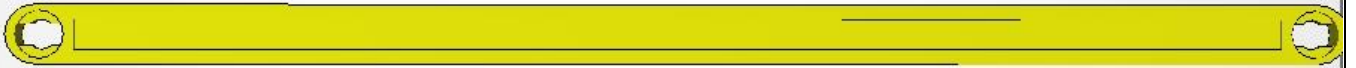

3 G

Flachträger 120
60Grad gebogen

Flachstück und
-träger 120

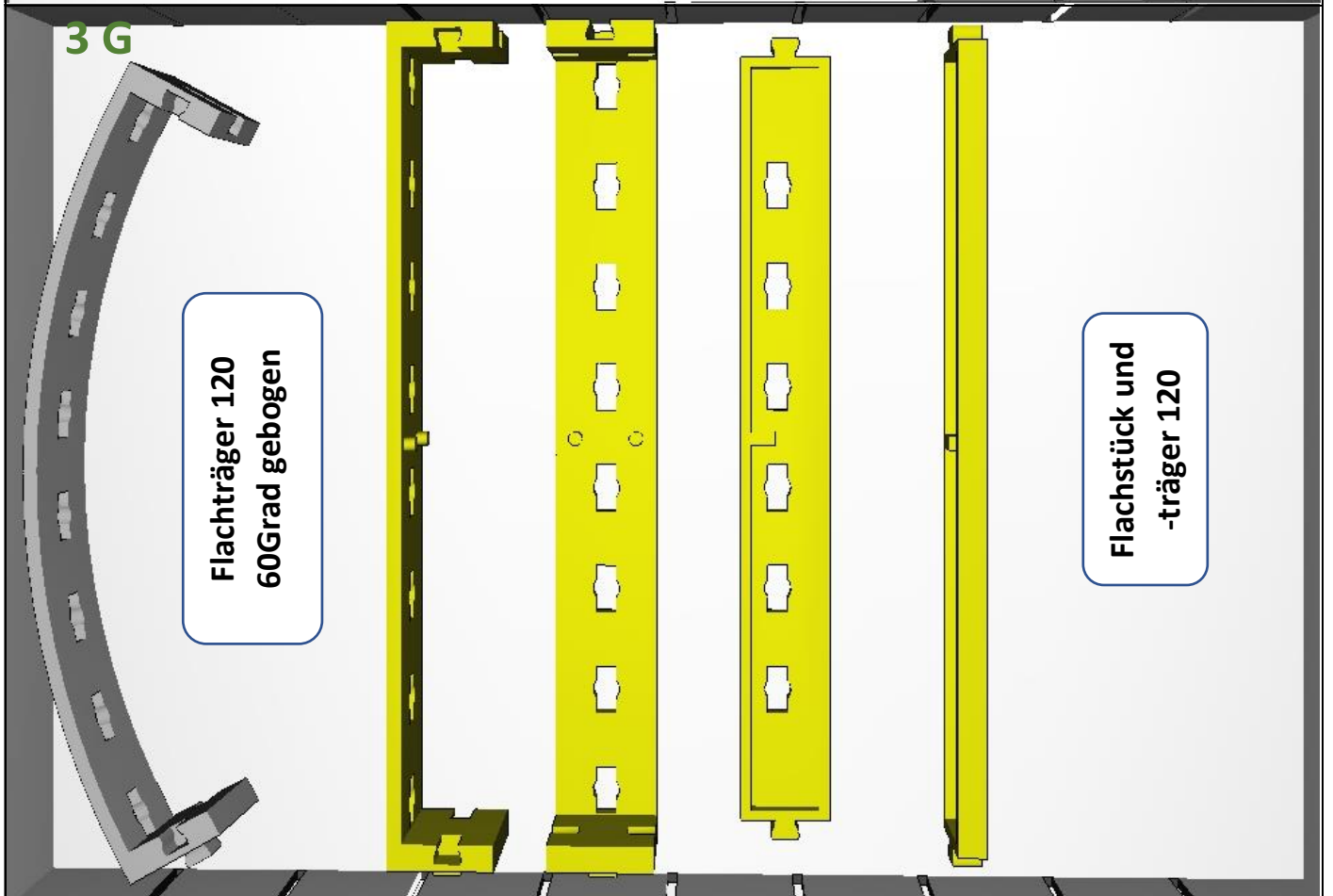

3 F



X-42,4



X-106

3 H

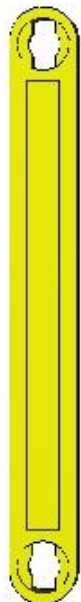

X-63,6



X-84,8

4 A



Adapterlasche

4 C



S-Riegel 6 mm



Riegelscheibe

4 B

S-Riegel 4 mm



Riegelschlüssel

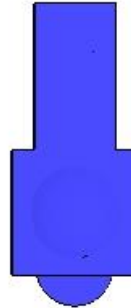

4 D

Winkelstein



Winkellasche



4 E

Verbindungsstücke



15 mm



30 mm



45 mm

4 G



Federnocken



Abstandsring

4 F



Hülse 15



Achsadapter



Klemmhülse



Strebenadapter

4 H



Klemmbuchse 5



Klemmbuchse 10



Mitnehmer

5 A

Gelenkklaue
und Würfel



Lagerhülse



5 C



Rastachse
mit Platte



Aufnahmeachse

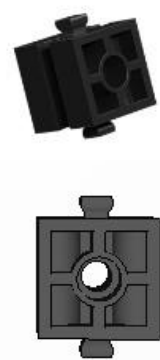

Baustein 15 mit
Ansenkung



Lagerstück
1 und 2

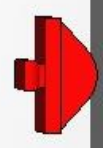

Kufe

5 B



Gelenkwürfel-Klaue

Gelenkwürfel
zusammgebaut



Gelenkwürfel-Zunge

5 D

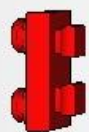

Statik-Adapter

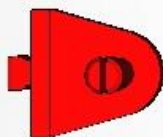

Radhalter



Reedkontakt-
und Kabelhalter



Kupplungsstück 30



Kupplungsstück

5 E

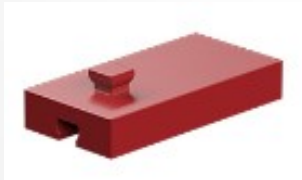
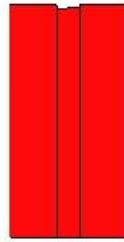

**Baustein 15x30x5
mit Nut und Zapfen**

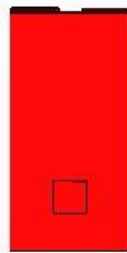

5 G

Lasche 21,2



L-Lasche

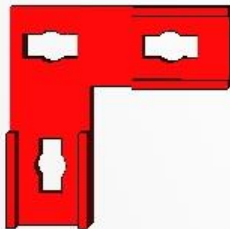

Lasche 15



Sternlasche

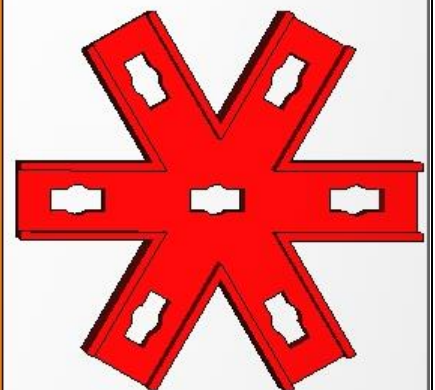

5 F

**Baustein 15x30x5
mit 3 Nuten**

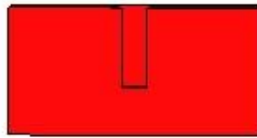
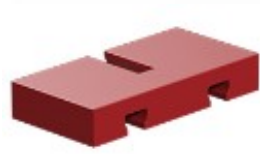
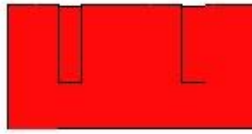

5 H

**Bauplatte
15x30x3,75 mit Nut**



6 A

6 C

Winkelstein 30°



6 B

**Baustein 5
(=0°)**

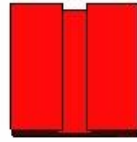

6 D

**Winkelstein 60°
mit 3 Nuten**



**Baustein
15x30 rund**

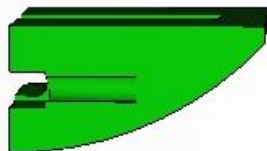

**Baustein
15x15 rund**



6 E



Winkelstein 15°

6 G

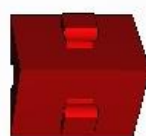

Winkelstein 60°

6 F

**Baustein 5
(=0°)**

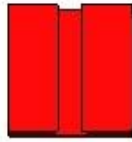

6 H

**Baustein 5
2 Zapfen**

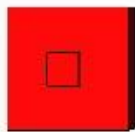

Winkelstein 7,5°

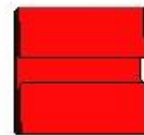

7 A

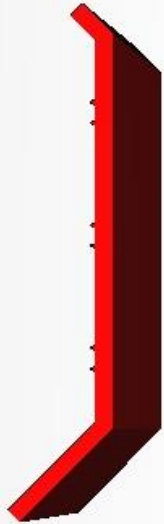

Kotflügel



Kotflügel

Kotflügel mit Zapfen

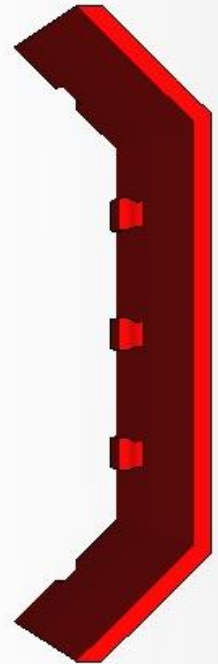
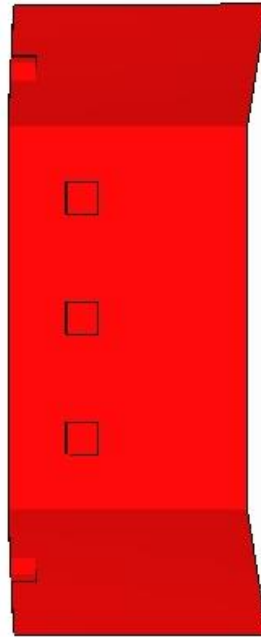

7 C

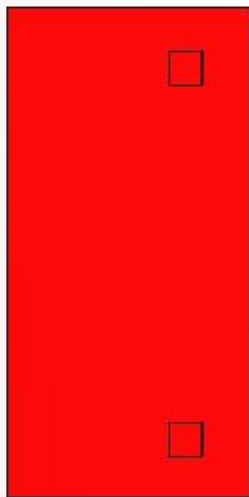

Bauplatte 30x60

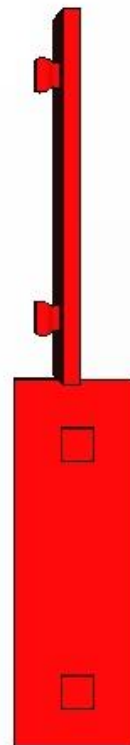

Bauplatte 15x45

7 B

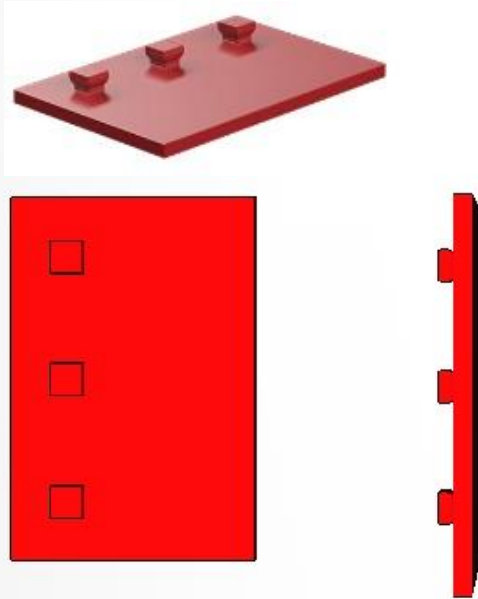

Bauplatte 30x45

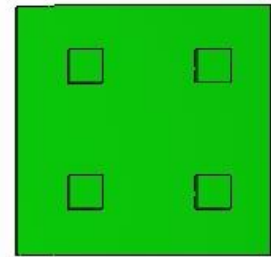

Bauplatte 30x30



7 D

Bauplatte 30x90

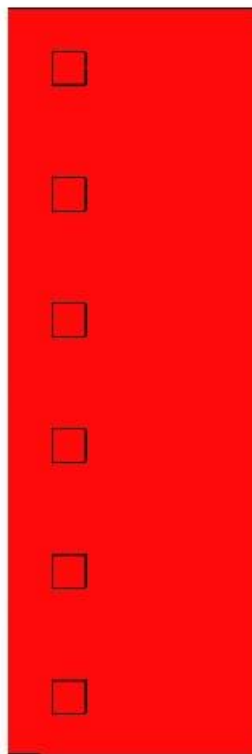

7 E

Bauplatte 15x60

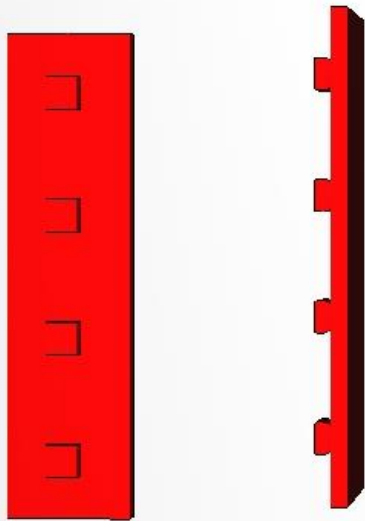

Bauplatte 15x90

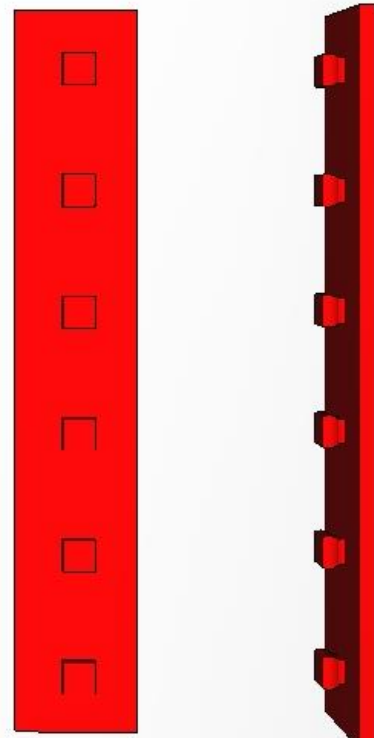

7 G

Bauplatte 15x15

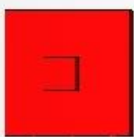

Bauplatte 15x60

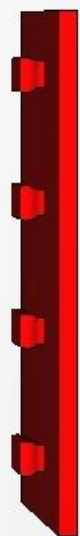
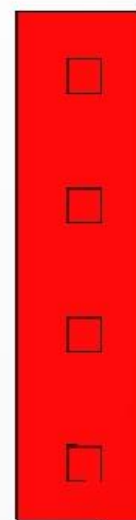

7 F

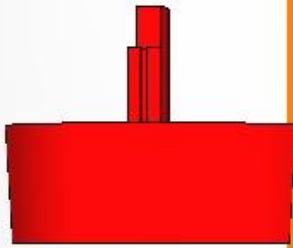

Kotflügel



Bauplatte 15x75

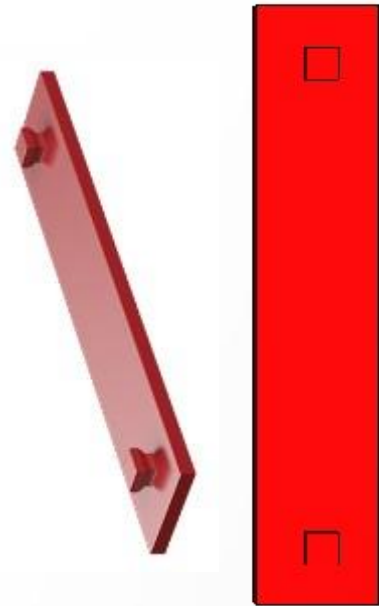

7 H

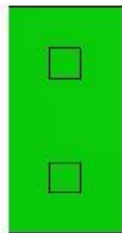

Bauplatte 15x30

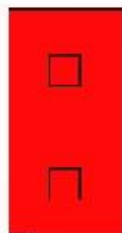

Bauplatte 15x45 mit 2x2 Zapfen

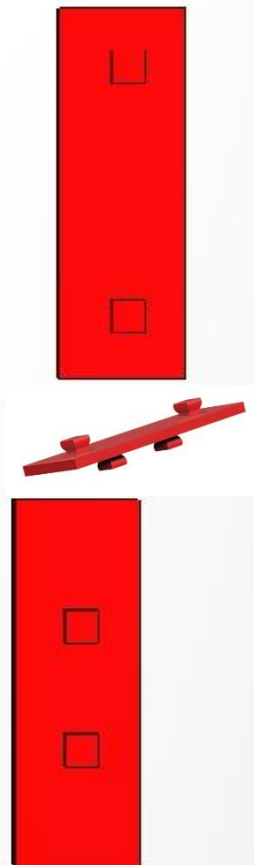

8 A

Lenkstock

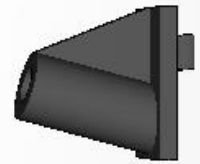

8 C

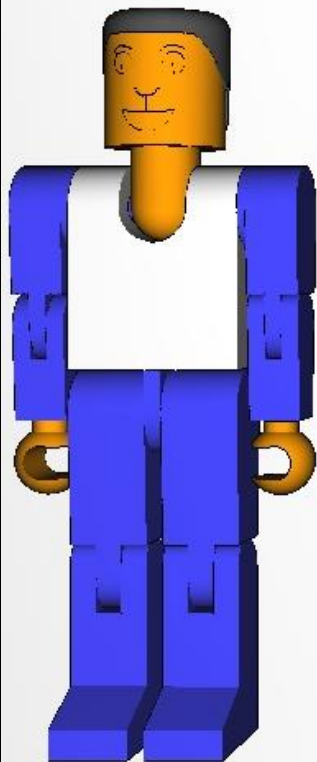

ft-Männchen



Zahnspurstange

8 B

Feder +
Federboden

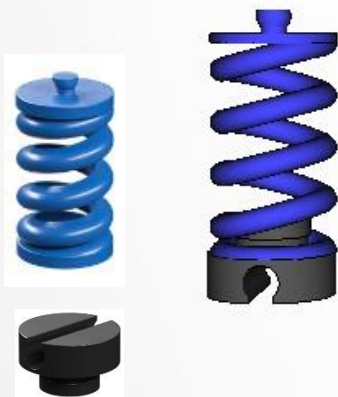

8 D

Lenkrad



Lenkradhalter
R 30

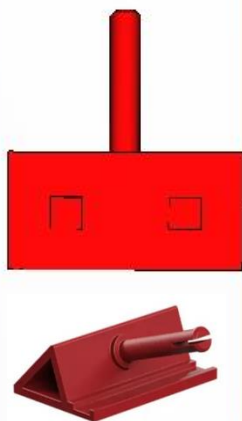

Gelenkstück



Spurstangen-
gelenk



Lenksäule 65

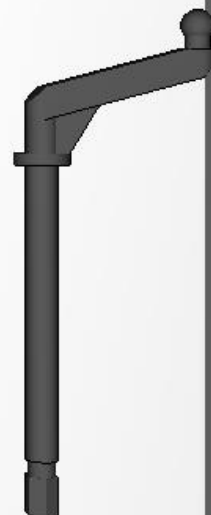

8 E

Sitzbaustein

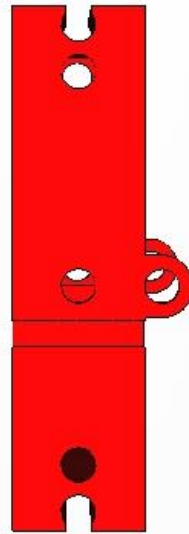

8 G

Schalensitz



Sitz

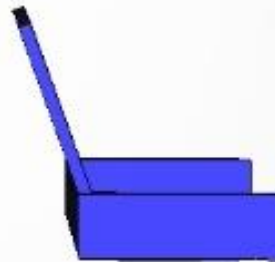

Anlenkhebel



8 F



Radachse



Lenkbalken

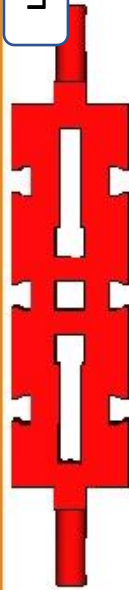

Schaufelhalter

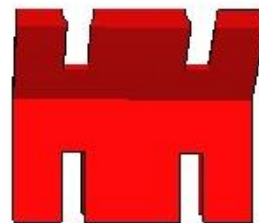

Kesselhalter

8 H

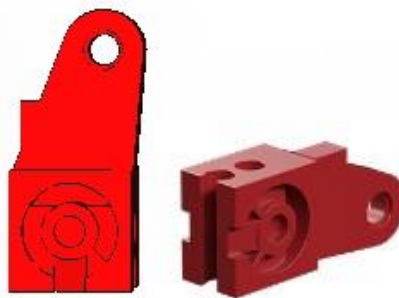
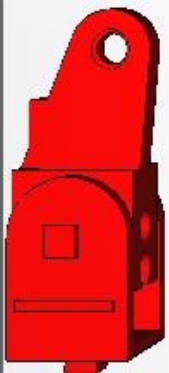

Lenkwürfel



Lenkklaue

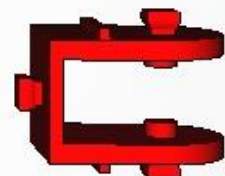

9 A

Muldenklappe

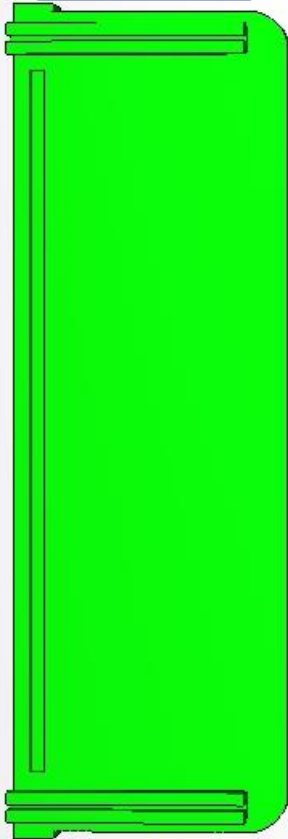

Seiltrommel
für
Rastachsen

Nabenmutter

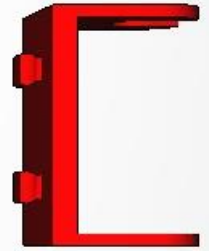

Seilwinden-
gestell 30

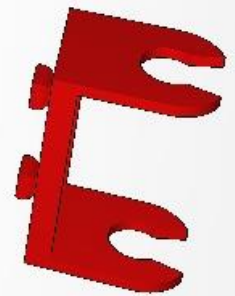

9 C

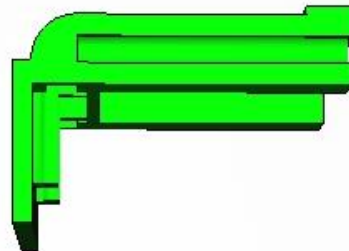

Muldenseitenteil

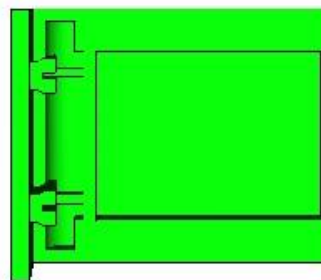

9 B



Seilwinden-
bremse



Seilhaken

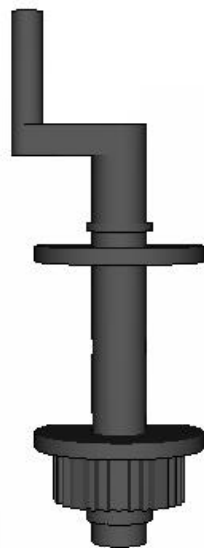

Seilwinden-
trommel

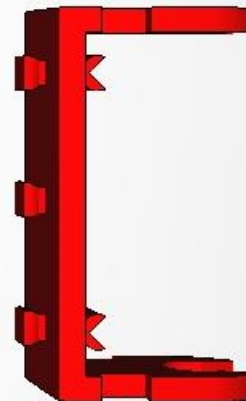

Seilwinden-
gestell

9 D

Radkappe
für
Felge 30

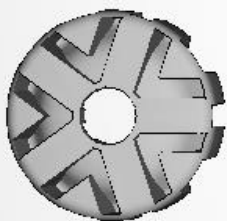

Felge 20,5x 12



O-Ring

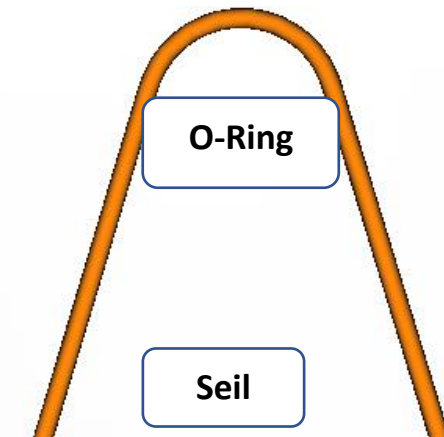

Seil



Klemmring +
Seiltrommel



Zylinder



9 E

Auflieger
Kupplung
Oberteil

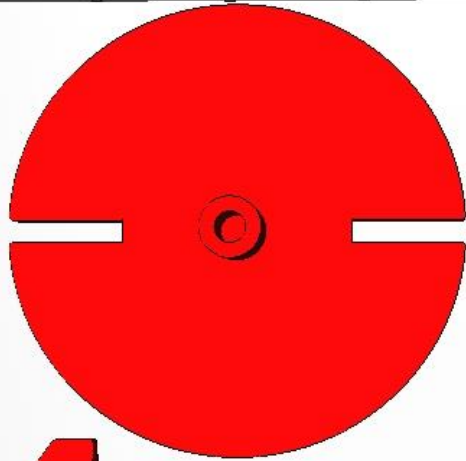

Auflieger
Kupplung
Unterteil

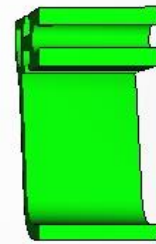
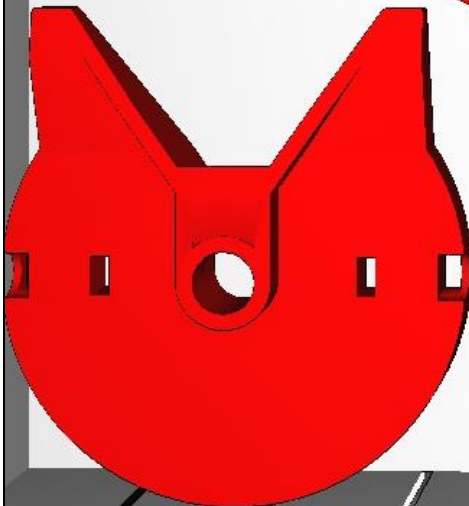

Verlängerung
Seitenteil

9 G

Seitenteil
rechts / links

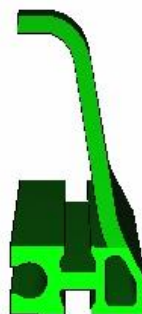
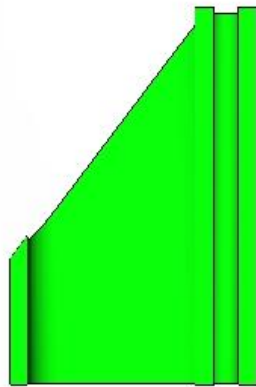

9 F



Rad 23

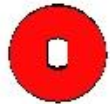

Rastrolle



Seilrolle
d=12



Rad 14

9 H



Seilrolle 21



Rollenlager



Rollenbock

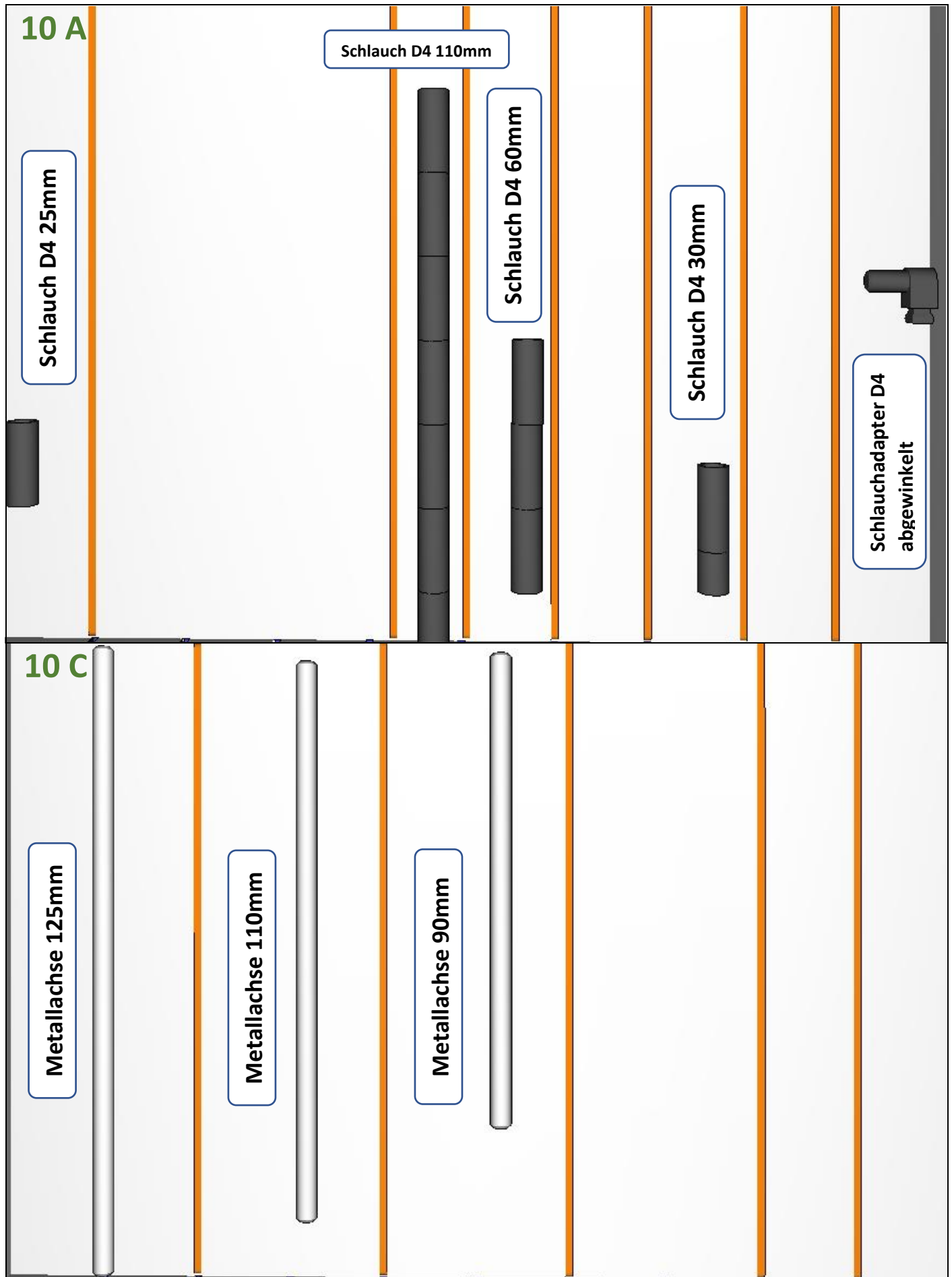

10 B



Verbinder

10 D



Rastadapter



Kardangabel für Rastachsen



Kardanwürfel

Rastkupplung



10 E



Lenksäule 34



V-Achse 4x80

V-Achse 4x98



Radachse



Rastachse 20



Verbindungsstopfen

10 G

Clipsachse



Kunststoffachse 30mm



Kunststoffachse 40mm



Kunststoffachse 50mm



Kunststoffachse 60mm



10 F

Rastachse 180mm



Metallachse 170mm



10 H



Rastachse 30mm



Rastachse 45mm



Rastachse 60mm



Rastachse 75mm



Rastachse 90mm

11 A

Schalt-
scheibe

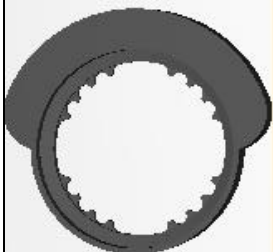

Ritzel
Z10 M1,5



Rast-Ritzel
Z10 M1,5



Zahnrad Z20



11 C

Innenzahnrad
Z30

Rastschnecke

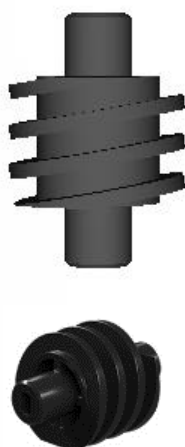

Differential



11 B



Flachnabenzange



Nabenmutter
mit Scheibe



Zahnstange
60, M1,5



11 D



Kegelzahnrad
mit Hülse



Differentialrad
Motor XM

Differential Antriebsrad Z14. m=1



Rastachse mit Kegelzahnrad



Rastkettenrad
Z20

11 E

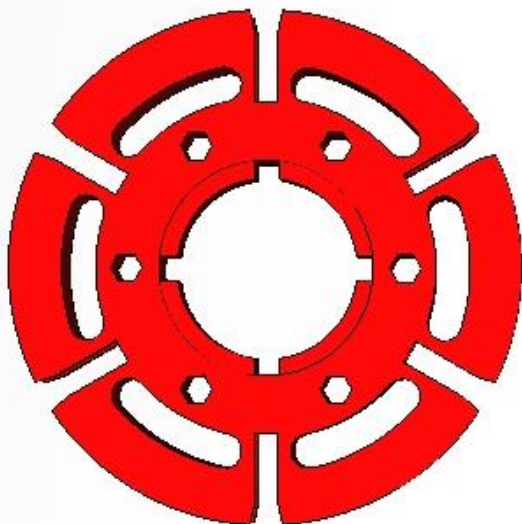

Drehscheibe 60

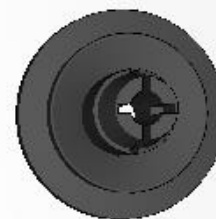

Freilaufnabe

11 G

Zangen-
mutter



Spannzange

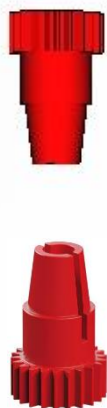

Schneckenteil
m = 1,5



Klemmbare
Schnecke m = 1,5



11 F



Zahnrad Z30

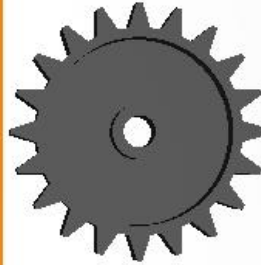

Kettenrad
Z20



Zahnrad
Z15

11 H

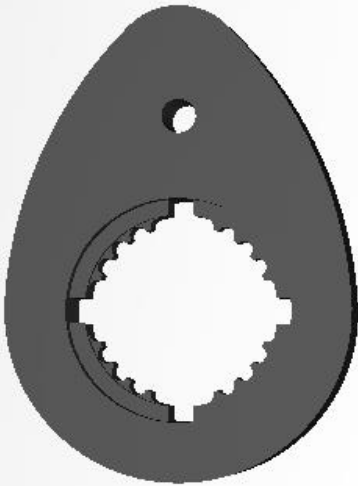

Nockenscheibe



Zahnrad Z40/32

12 A

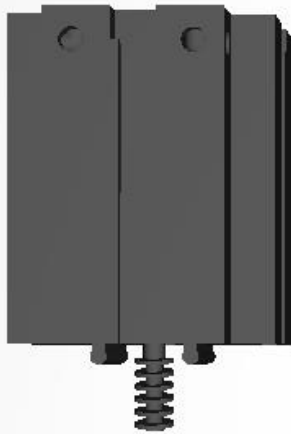

Mini Motor 6 – 9V

U-Achse 60 mit Zahnrad Z28



Differential Z15 m1,5

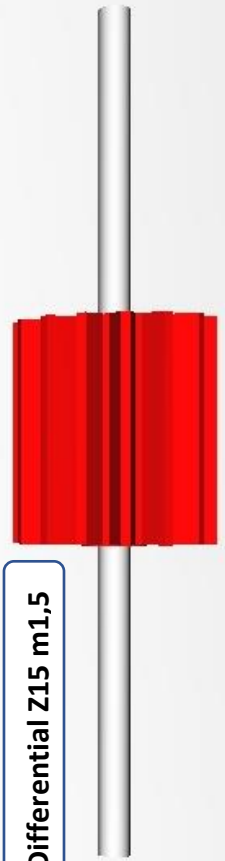

12 C

U-Achse 40
mit Zahnrad
Z28

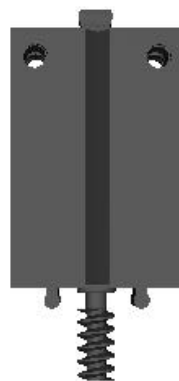

XS-Motor 9V

12 B



Rastachse mit
Zahnrad Z28 m = 0.5



U-Achse 40 mit
Zahnrad Z28

12 D

Getriebehalter
mit Schnecke
m=1,5

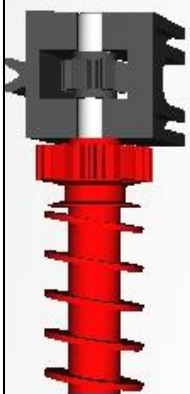

U-Getriebe

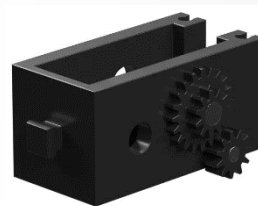
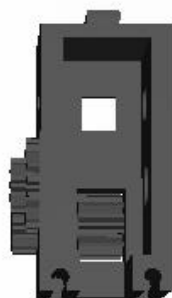

12 E

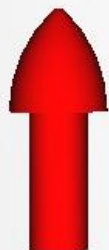

Adapterspitze für
Luftschrauben

Luftschraube 100

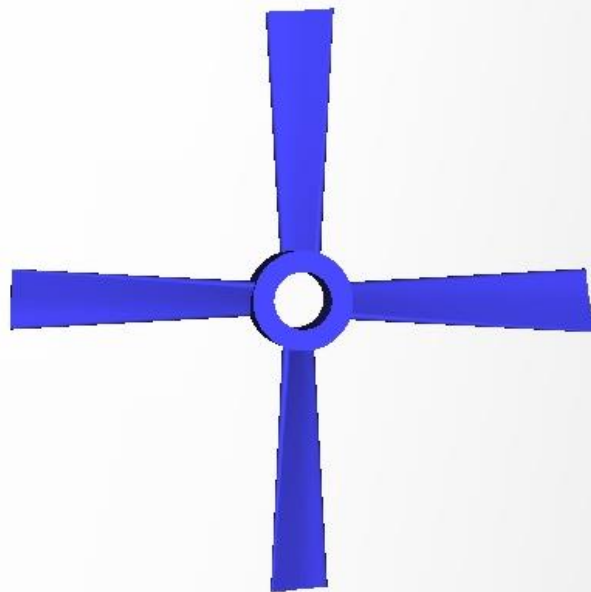

Luftschraube 4 Flügel

12 G



Schneckenmutter
m = 1.5



Schneckenmutter
m = 1

Rastachse mit Schnecke m = 1



Gelenkkurbel

12 F

Rückzugsmotor

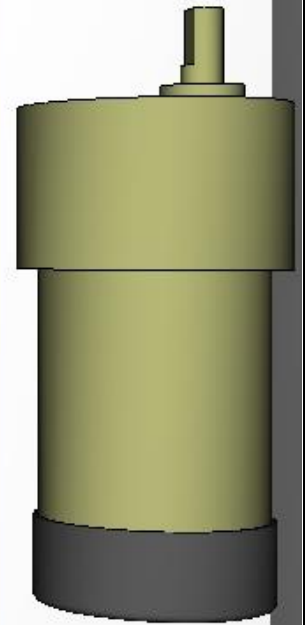
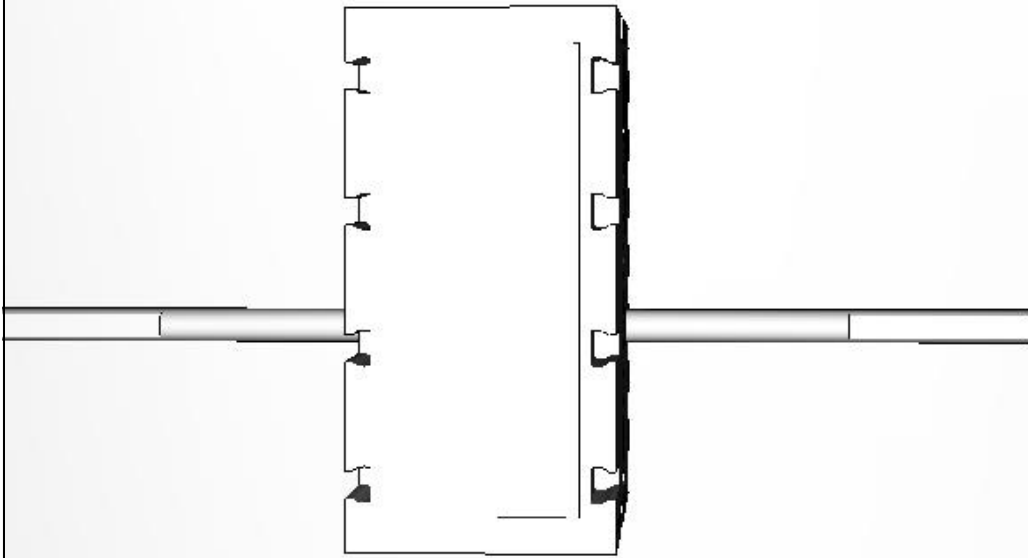

Powermotor 9V=
(8:1) 1A max

12 H

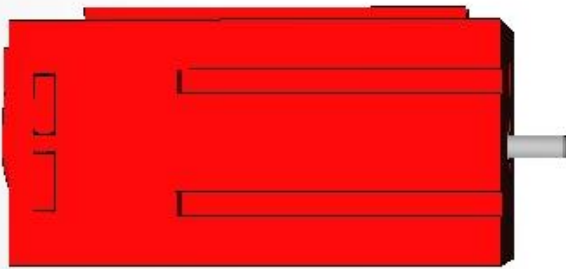

Encodermotor 9V

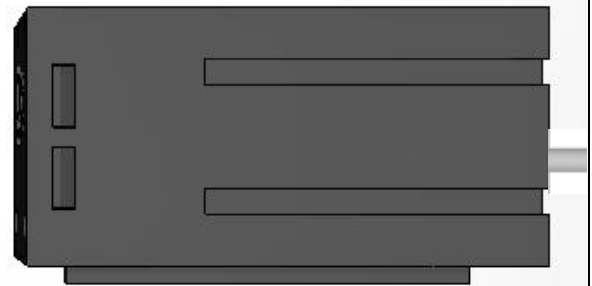
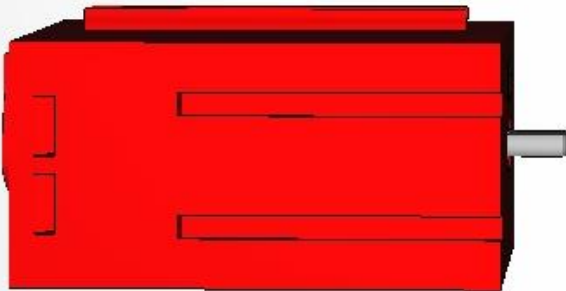

Motor XM 9V

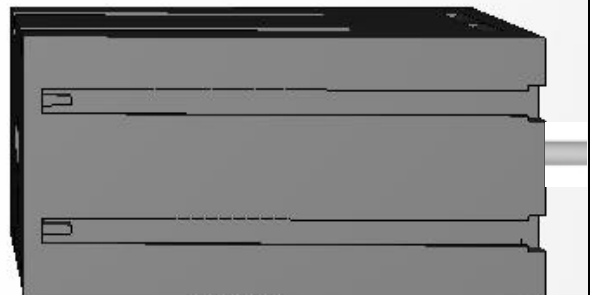

13 A

Rastkettenglied 13,5

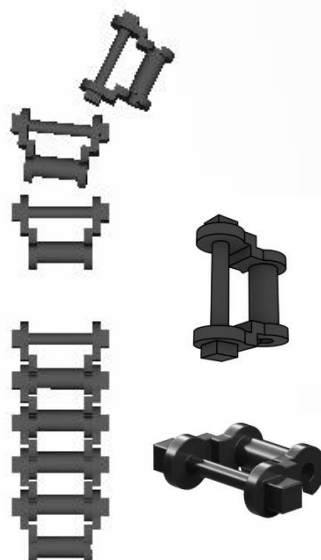

13 C

Rastraupenbelag weich



13 B

Rastkettenglied 11,5

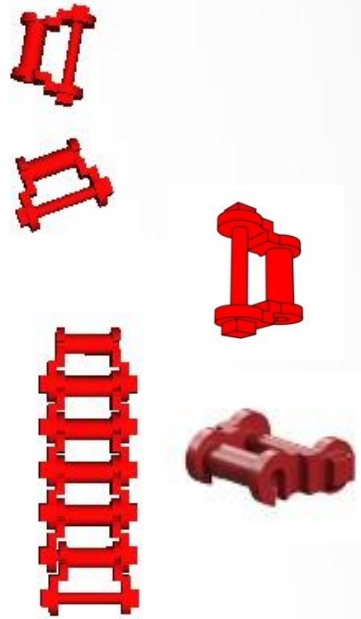

13 D

Rastraupenbelag weich



13 E

Kurve 90°

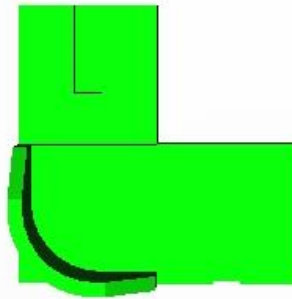

13 G

Magnetischer
Kugelhalter



Wechselweiche
Rasthebel



Stahlkugel



Wechselweiche
Oberteil

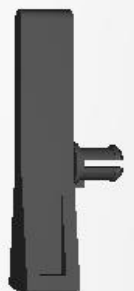

13 F

Kurve 180°

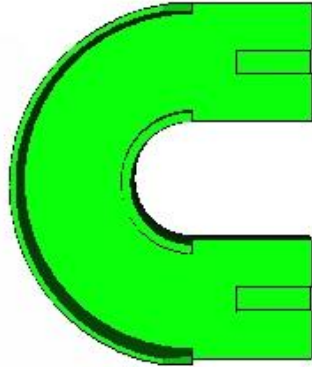

13 H

Flexprofil 90

Flexprofil 90

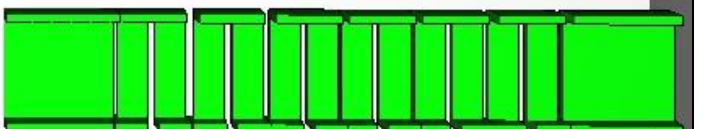
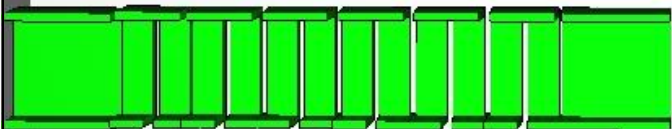
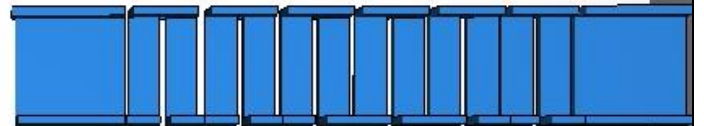

14 A

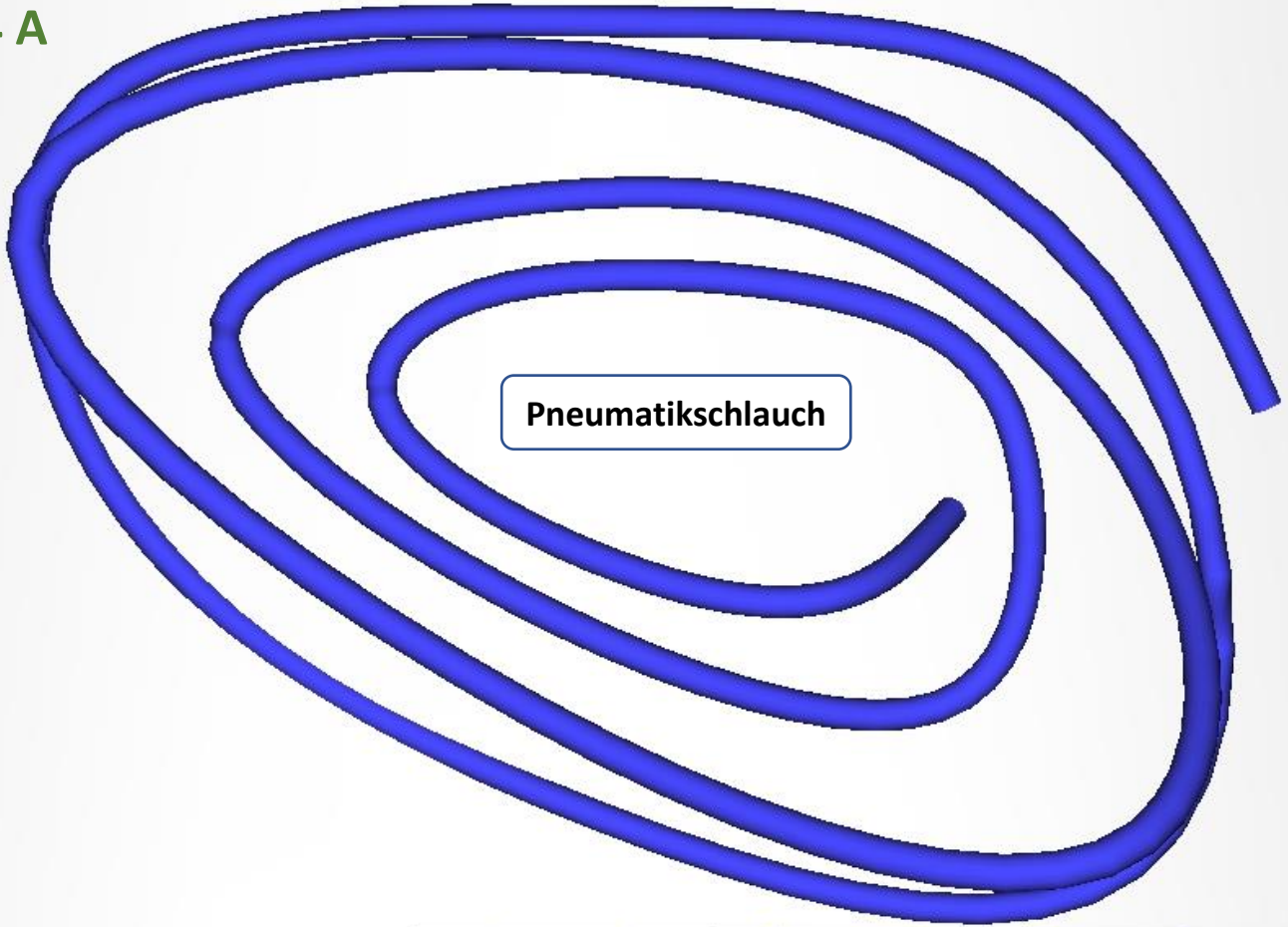

14 C

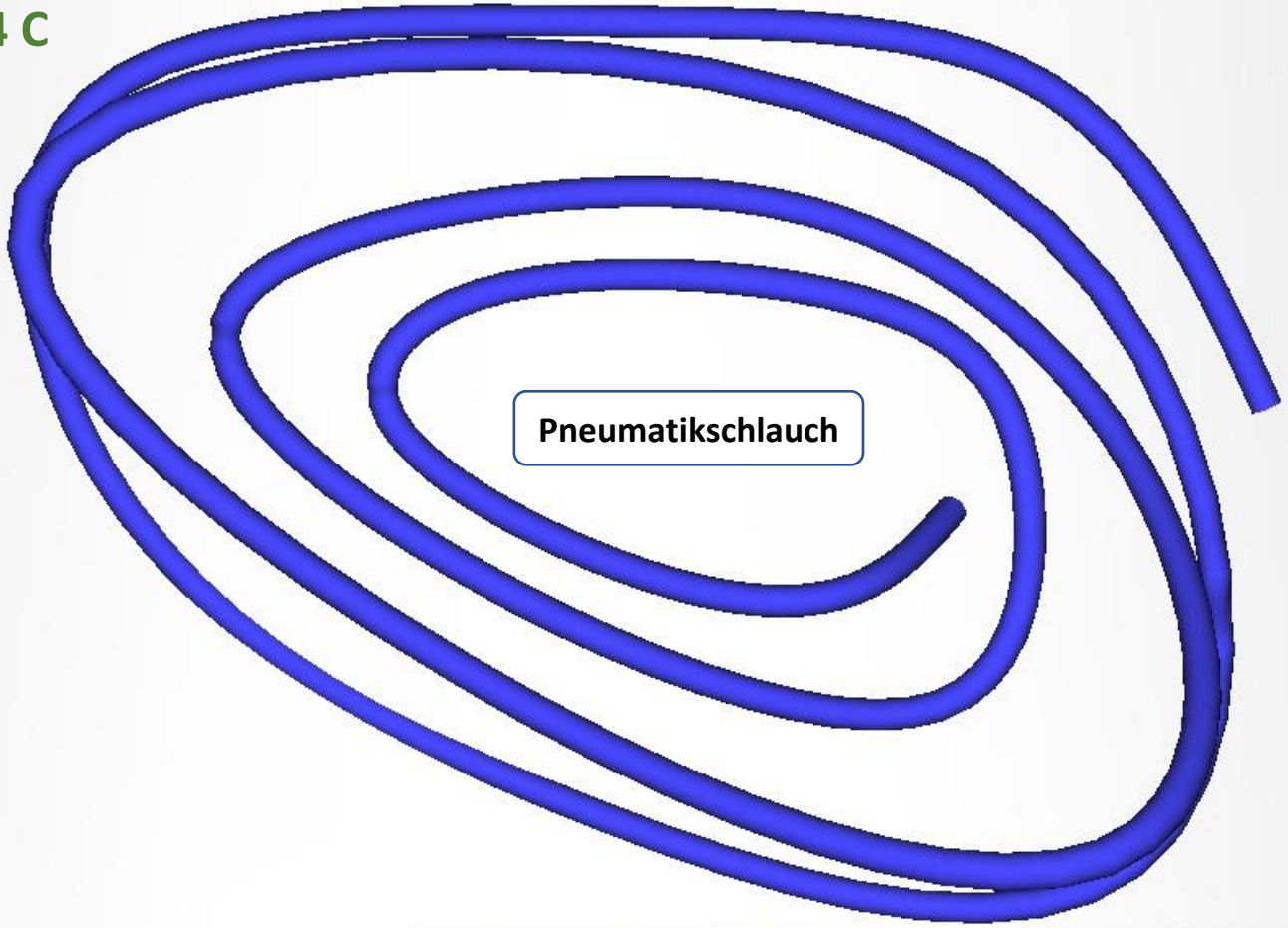

14 B

Zylinderrohr 44
mit Kopf

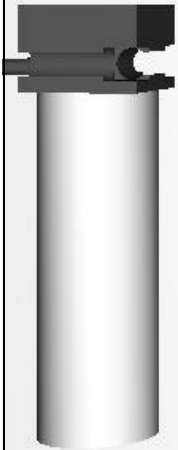

Pneumatik-
Zylinder 60



Pneumatik-
Zylinder 45

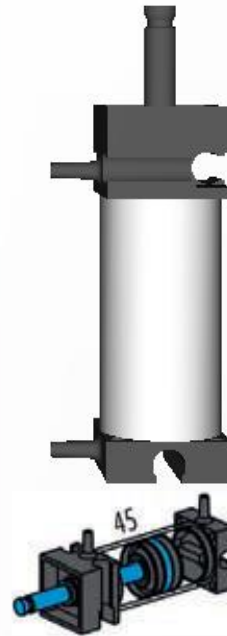

14 D



Kompressor 9V

14 E

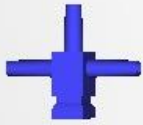

T-Stück

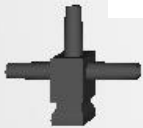

Winkelanschluss

Vakuumsauger

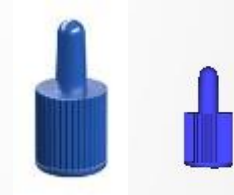

P-Stopfen

14 G

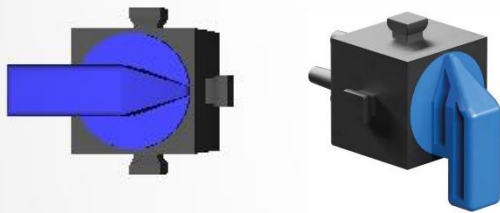

Pneumatik-Handventil

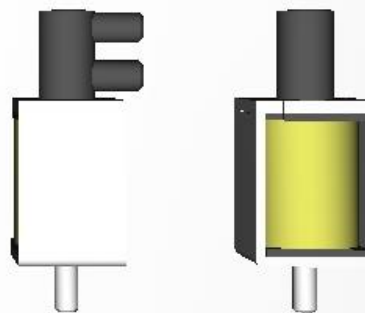

3/2-Wege-Magnetventil

14 F

Abluftdrossel
Gehäuse



Abluftdrossel
Schraube

14 H

Greifzange kurz



Rohrhülsen
30x45



Rohrhülsen
30x60

Rohrhülsen
30x20 mit Deckel

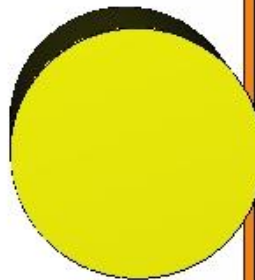

Tischtennisball

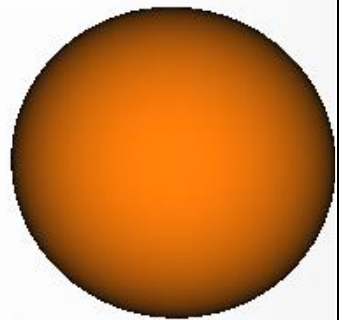

15 A

Störlichtkappe,
Öffnung 6



Mini-Taster

Fototransistor
montiert

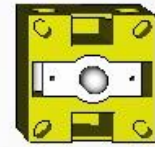

Fotowiderstand

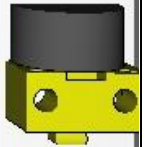

15 C

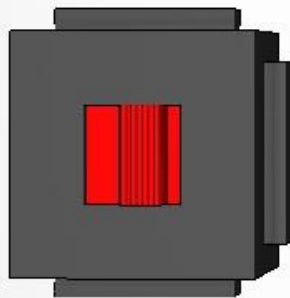

Polwendeschalter

Taster

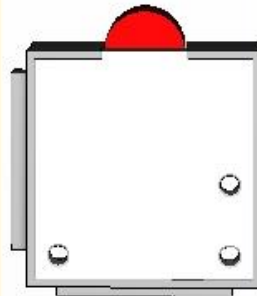
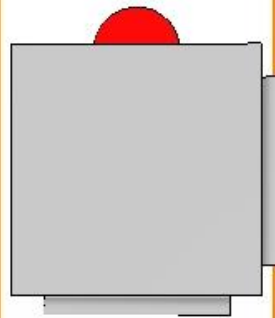

15 B

Linsenstecklampe

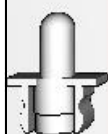
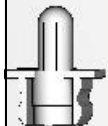

Rastleuchtkappen rot

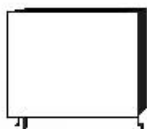

Rastleuchtkappen weiß

Leuchtstein mit Steckfassung

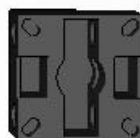

LED montiert



15 D

LED grün



NTC-Widerstand
1,5 k Ω

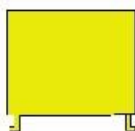

Rastleucht-
kappen
gelb

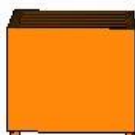

Rastleucht-
kappen
orange



Rastleuchtkappen blau



Rastleuchtkappen grün

15 E



Schraubendreher

15 G

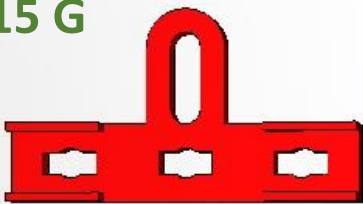

Servolasche

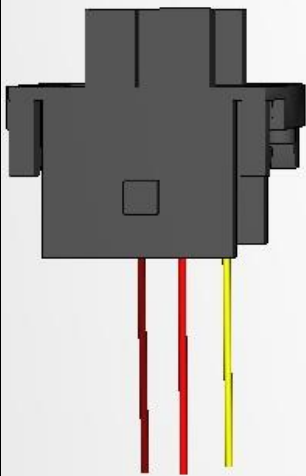

Servohalter

Farbsensor

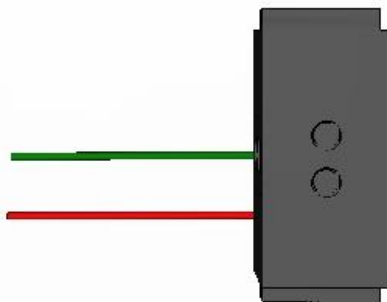

15 F

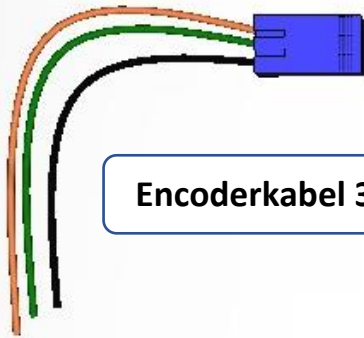

Encoderkabel 3adrig

Kabel



15 H

Stecker

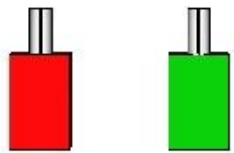

Stecker

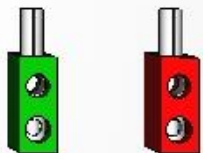

16 A

16 C

16 B

16 D

16 E

16 G

16 F

16 H

Box 1 Baustein 30



Box 2 Winkelträger 120

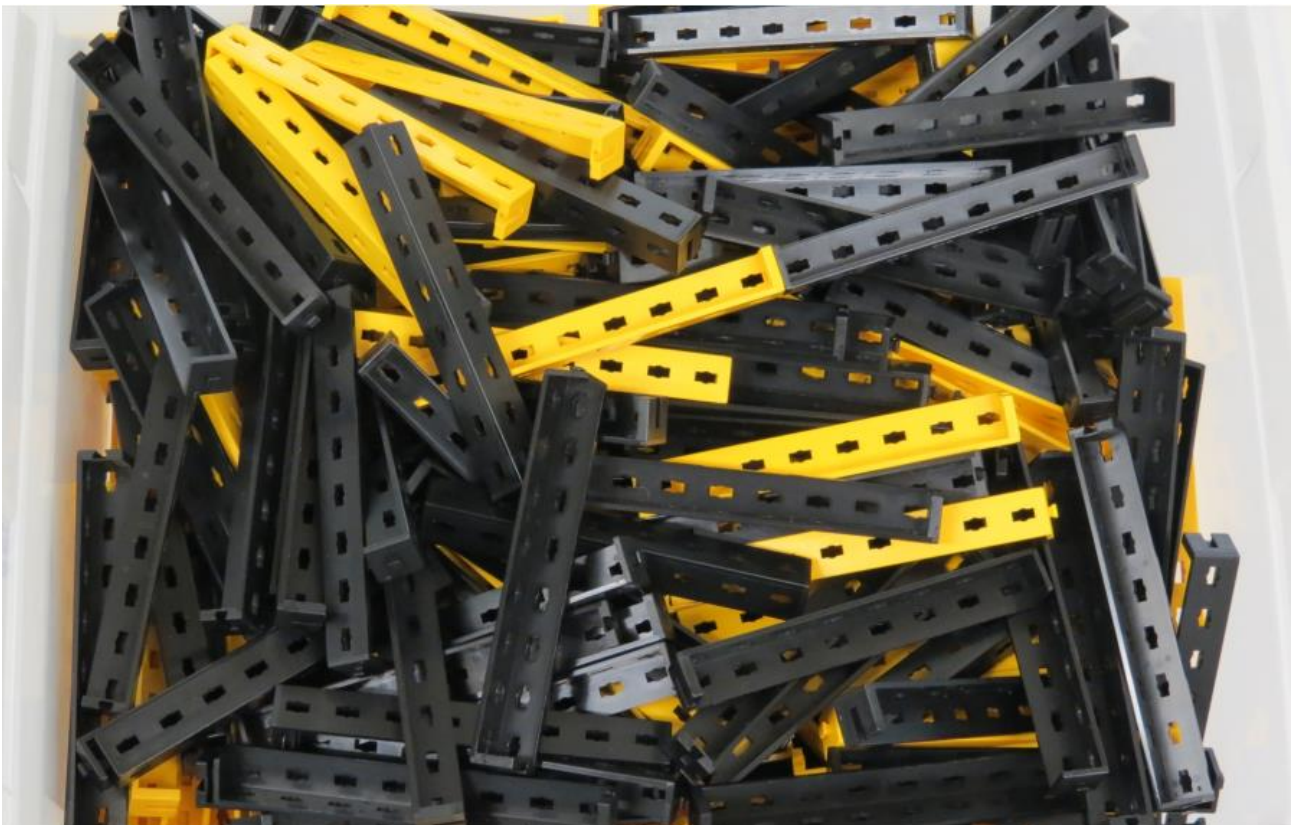

Box 3 Winkelträger 60



Box 4 Winkelträger 30



Box 5 Kabel, Netzteile, Akkus und Batteriehalter

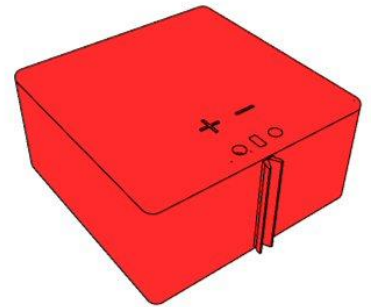
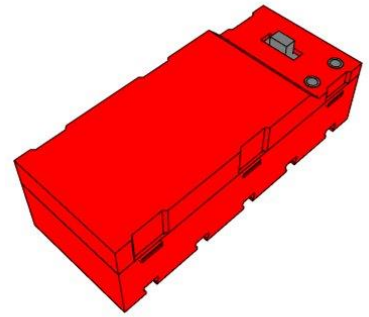

Box 6 Platten

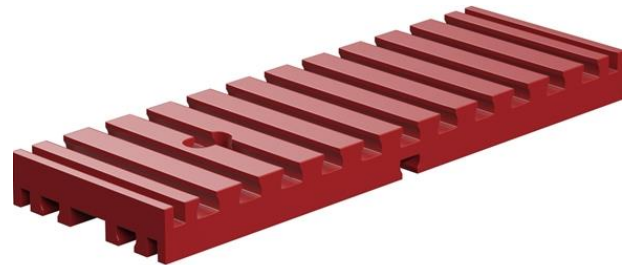
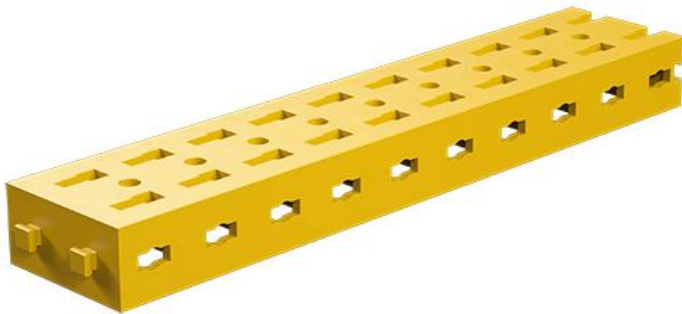

Box 7 Omniwheel-Räder



Box 8 Räder



Box 9 Trichter und Wechselweiche



Box 10 Schläuche und Flexprofil 180mm

